

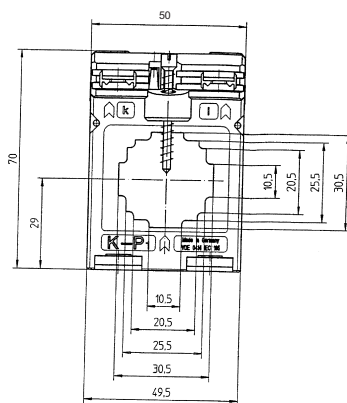

ASK 231.5

Aufsteck-Stromwandler

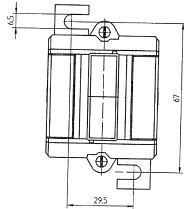
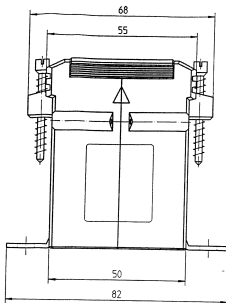

Sekundärstrom		5A		1A	
Primär-Strom A	Bem.-Leist. VA	Genauigkeitsklasse		Genauigkeitsklasse	
		1	0,5	1	0,5
		Best.-Nr.	Best.-Nr.	Best.-Nr.	Best.-Nr.
50	1	92050		92250	
	1,25	92051		92251	
60	1	92052	92012	92252	92212
	1,25	92053		92253	
75	1,25	92054	92014	92254	92214
	2,5	92055		92255	
80	1,25	92056	92016	92256	92216
	2,5	92057	92017	92257	92217
	5	92058		92258	
100	1,5	92059	92018	92259	92218
	2,5	92060	92019	92260	92219
	5	92061		92261	
125	1,5	92062	92020	92262	92220
	2,5	92063	92021	92263	92221
	5	92064		92264	
150	1,5	92065	92023	92265	92223
	2,5	92066	92024	92266	92224
	5	92067	92025	92267	92225
200	2,5	92068	92026	92268	92226
	5	92069	92027	92269	92227
	10	92070		92270	
250	2,5	92071	92028	92271	92228
	5	92072	92029	92272	92229
	10	92073		92273	
300	2,5	92074	92030	92274	92230
	5	92075	92031	92275	92231
	10	92076		92276	
400	2,5	92077	92032	92277	92232
	5	92078	92033	92278	92233
	10	92079	92034	92279	92234
	15	92080		92280	
500	2,5	92081	92035	92281	92235
	5	92082	92036	92282	92236
	10	92083	92037	92283	92237
	15	92084		92284	
600	2,5	92085	92038		
	5	92086	92039		
	10	92087	92040		
	15	92088			

Primärleiter	30 x 10 mm
Rundleiter	Ø 28,0 mm
Wandlerbreite	50 mm
Schnappbefestigung	–
Plombierplatte	–

ASK 231.5

Plug-in current transformer

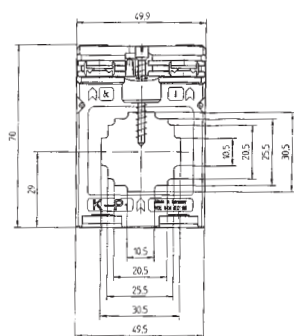
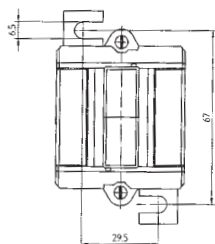
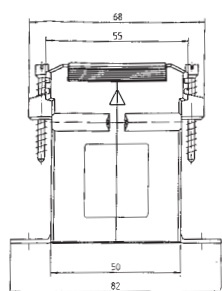

Secondary current		5A		1A	
Primary current A	Burden VA	Accuracy class		Accuracy class	
		1	0,5	1	0,5
		Art.-no.	Art.-no.	Art.-no.	Art.-no.
50	1	92050		92250	
	1,25	92051		92251	
60	1	92052		92252	
	1,25	92053		92253	
75	1,25	92054		92254	
	2,5	92055		92255	
80	1,25	92056		92256	
100	1,5	92059		92259	
	2,5	92060			
125	1,5	92062	92020	92262	92220
	2,5	92063		92263	
150	1,5	92065	92023	92265	92223
	2,5	92066		92266	
200	2,5	92068	92026	92268	92226
	5	92069		92269	
250	2,5	92071	92028	92271	92228
	5	92072	92029	92272	92229
300	2,5	92074	92030	92274	92230
	5	92075		92275	
400	2,5	92077	92032	92277	92232
	5	92078	92033	92278	92233
	10			92279	
500	2,5	92081	92035	92281	92235
	5	92082	92036	92282	92236
	10	92083		92283	
600	2,5	92085	92038		
	5	92086	92039		
	10	92087			

Primary conductor	30 x 10 mm
Round conductor	Ø 28.0 mm
Transformer width	50 mm
Snap-on mounting	—
Sealed shutter	—